

CVF Court Facilities LIMASSOL



Proposed Beach Volleyball Courts

Upgrade Plan

Cyprus Volleyball Federation

Area Top View

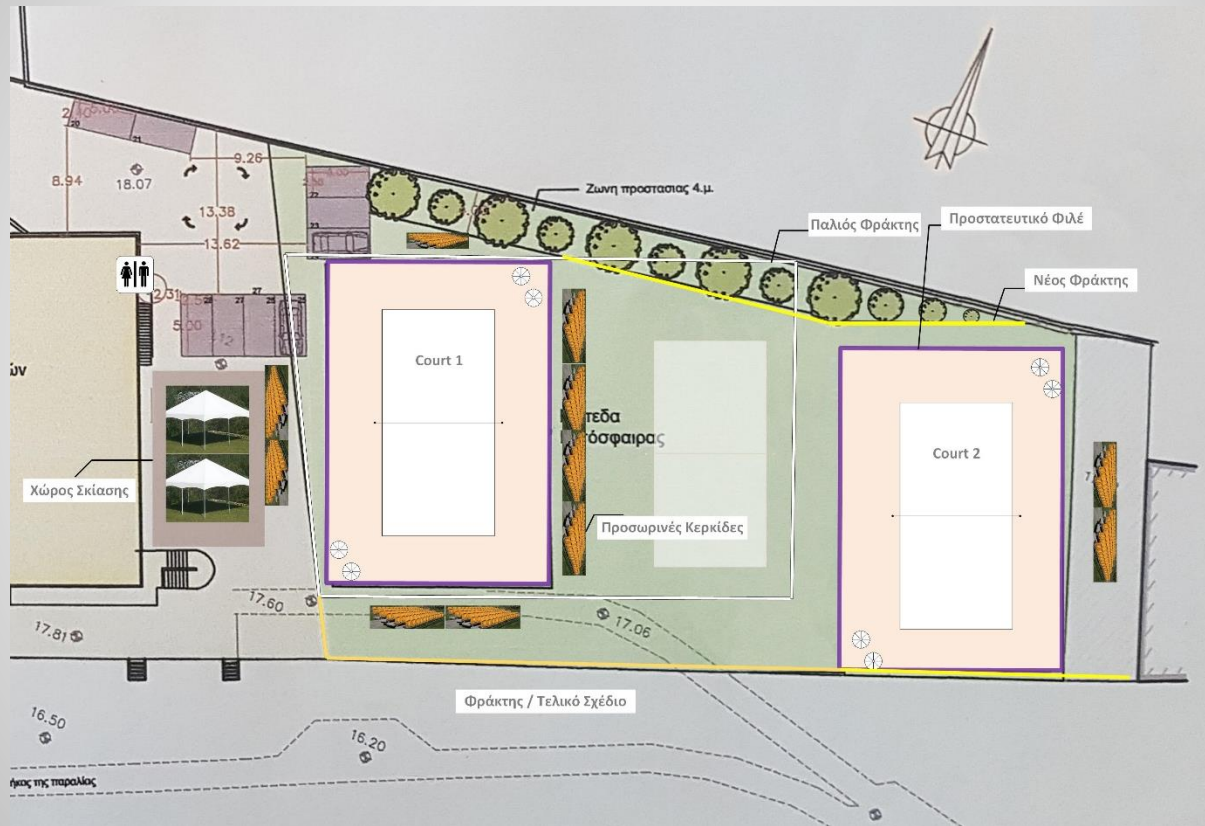

Proposed Playing Area

The playing area (according to international regulations) consists of the inner court and a five meters security area around it.

The dimensions of each beach volleyball court are 8m x 16m (outer edge of boundary lines).

The surrounding security area is considered as playing area and should be free from any obstacles. The playing area must be flat and should consist of good quality sand with 40cm thickness, in order to prevent the contact of the players with the underlying surface.

Combined with the surrounding security area, the dimensions of the playing area should be at least 18m x 26m.

In this area, the CVF will have two playing fields based on international standards, along with spectator stands. Around the two playing courts, net protection (of about 4m) will be raised.

Between the two courts, a training court has been designed, which will be temporarily raised during tournaments. The premises (sand, surrounding walls, etc.) of the two playing courts will be unified, in order to be easily converted whenever needed.

Spectator Stands

In order to enable the site to host local and international tournaments, there must be spectator stands present with a total seating capacity of 200 seats. One of these stands is intended for officials (VIP), with a capacity of at least 40 spectators. The VIP stands must be shaded.

Other Proposed Facilities

In order for the site to operate as a training center, in addition to being a tournament playing field, the CVF proposes that the site should also include the following:

1. Men Dressing Area
2. Women Dressing Area
3. Management Office with storage
4. Men and Women toilettes
5. Showers
6. Stadium Lighting (optional)

Other Facilities

With the fulfillment of the proposed project, the CVF feels that the facilities will be adequate to serve both as a field for training and as a field for conducting regional and other small international tournaments. The design does not provide for a canteen at this stage.

Court Equipment

The proposed installation material (for each court) is the following:

1. 2 Net Posts (with protection)
2. 2 Net Antennas
3. 1 Net
4. 1 Court Marking Line
5. 1 Referee Stand (with protection)
6. Protection net (at least 4m high) around the courts

Preparation / Court Construction

The playing area within the surrounding walls should be excavated to approximately 0.7m - 1m depth, depending on a drainage study that should be performed. There may be a need to create one (or more) drainage ditches, in order to lead the water away through the lowest point of the area. Proper drainage is extremely important!

Depending on the quality of the lower sand (sewage), a gravel layer of 30cm - 40cm thickness should be placed over it.

Over the gravel, geo-fabric should be installed that will prevent the sand from being washed out by rain. The fabric should be sufficiently thick in order to prevent any sand loss.

Sand / Purchase Calculation

Court Name / Cost Type / Parameter	Area Sizes		Perimeter Width (in meters)	Total Length (in meters)	Total Width (in meters)	Area Covered (in sq.m.)	Depth (in meters)	Volume (in cubic meters)	
Area 1 / Displaced & Wasted Sand				40	2	80	0,70	56,00	
Area 2	10	20				200	0,40	80,00	
							Total c.m.	136,00	
tons/cubic meter	€	1,60						Total tons	217,60
Probable Price (in euros per ton) *	€	55,00							
Total Price of Sand (in euros)	€	11.968,00							
VAT (18%)	€	2.154.24							
Shipping / Duties / Local Transport (est.)	€	1.500,00							
Total sand Purchase	€	16.622,24							

* Egyptian Sand

Construction / Court Relocation Cost (based on Town Planning and Housing Department plan)

Κόστος Αλλαγών που χρειάζονται για Πολεοδομική Άδεια	
Οργανικά Υλικά / 200 τόνοι	3.500
Τρακτέρ με οδηγό (για όλη την διάρκεια του έργου)	2.000
Μεταφορά, μετακίνηση άχρηστων χωμάτων	1.000
Ανακύκλωση Κουγκριών / Ασγάτα	600
Σκουπίδια / Βατί	250
Αγορά και τοποθέτηση Γεω-υφάσματος (500 τ.μ.)	1.200
Βίδες για Στύλλους (ολόπασες)	250
Αγορά πράσινου προστατευτικού δικτύου	150
Εντοιχισμός Γηπέδων / 80μ. x 20εκ.	5.000
Κατασκευή Σίτα για καθαρισμό Άμμου, καθαρισμός και ψεκασμός	1.500
Περίφραξη Γηπέδων (Συρματόσχοινο, Δίκτυ Προστασίας) / 170μ x 4μ	1.800
Πληρωμές Εργατικού Προσωπικού / 10 μέρες εργασία	1.000
Σύνολο Κόστους Αλλαγών για Πολεοδομική Άδεια	18.250

Budget

The budget of the entire project has been calculated as closely as possible, but at this stage, it cannot be exactly ascertained, because the cost of the various tasks / materials, along with the construction, should be put to tender procedure.

Μελέτη Έργου, Σχεδιασμός, κλπ	
Άδειες	
Έργα Αλλαγής Υφιστάμενου Χώρου για έκδοση πολεοδομικής άδειας (προηγούμενη σελίδα)	17.250
Νέα Έργα (τελικό σχέδιο)	
Επιχωμάτωση / Καθαρισμός	3.000
Αποχετευτικά / Ντουζιέρες	400
Κερκίδες	20.000
Επίστρωση Χαλικιού	
Αγορά / Μεταφορά/Επίστρωση Άμμου	16.622
Αγορά, Επίστρωση Γεω-υφάσματος	
Νέος Εντοιχισμός	3.000
Περιφερειακή Περιφραξη (Στύλοι / Συρματόσχοινο, Δίκτυ Προστασίας)	
Περιφερειακός Φράκτης ύψους 1μ.	2.500
Σύνολο Νέων Έργων	45.522
Εγκαταστάσεις	
Ηλεκτρική Εγκατάσταση / Παροχή	2.000
Παροχή Νερού	500
Αποδυτήρια /Αντρών Γυναικών	
Γραφείο	
Τουαλέτες Ανδρών και Γυναικών	
Ντουζιέρες	
Φωτισμός / Ηλεκτρολογικά	
Κεντρικός Χώρος Σκίασης	2.000
Ψυγεία	1.500
Αποθηκευτικός Χώρος	
Καρέκλες Τραπέζια	1.800
Σύνολο Εργασιών Εγκαταστάσεων	7.800
Γηπεδικά / Αγωνιστικά	
Στύλοι φιλέ (με προστατευτικά)	1200
Φιλέ, Αντένες, Γραμμές	400
Σκάλες διαιτητή (με τα προστατευτικά)	1600
Ομπρέλες Γηπέδων	300
Πίνακες Αποτελεσμάτων	800
Σύνολο Γηπεδικών / Αγωνιστικών	4300
Γενικό Σύνολο	74.872

Cantine Setup Needs

1. Application to the EAC for electricity installation and supply.
2. Application to the water authority for supply and installation of water.
3. Installation of outdoor canteen with cafe specifications and snack bar with tent, tables, chairs and benches
4. Obtain operating permit from the local council (St.Tikhon).
5. Obtain operating license from the Cyprus Tourism Organization (CTO)
6. Construction of new Toilets (if not provided by CSO) .
7. VAT (Value Added Tax) Registration

Εργασίες που άρχισαν / Work is currently under Way



TRAINING CENTER

CYPRUS VOLLEYBALL FEDERATION



Game, Entertainment, Sports